

Installation Sheet

Skyfixture Panel series

Product Description

Redilight flat Skyfixture panels;

1. Panel sizes available: 6x6 and 12x3
 - 6x6 - Actual Panel size: Overall 595 x 595mm with a **hole cutout of 575 x 575mm**
 - 12x3 - Actual Panel size: Overall 1195 x 295mm with a **hole cutout of 1175 x 275mm**
2. Soft lighting and non-glare surface adopting highly efficient SMD as its illuminant
3. Using progressive circuit design, each set of LED's works independently to avoid single led failure.
4. Anti-EMI, mercury-free, lead-free, compliant with CE and RoHs requirements.

Product Details

1. This product is suitable for indoor use only.
2. Before use, please confirm the products are intact during transportation.
3. Keep packing materials away from children to prevent any danger of suffocation.
4. Non authorized personnel are not permitted to disassemble or repair any Redilight Products. Redilight has the right to refuse the replacement or warranty service for the unauthorized disassembly or repaired products.
5. Clean with moist cloth, do not use harsh chemicals or corrosive materials for cleaning.

Applications

Hotel foyers, meeting rooms, offices; residential housing and public facilities, commercial use, schools, hospitals, other lighting.

Dear User:
Thank you for purchasing our products,
please review to ensure proper
installation and operation.

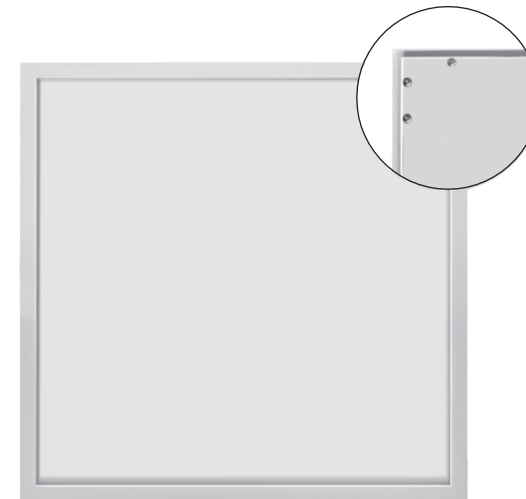

Skyfixture Panel installation options

Note before installation:

1. Always follow electrical wiring standards applicable to your location
2. Once the location of your Skyfixture has been established be sure to clear any electrical cables or debris from where you are about to cut the hole in the ceiling.

Installation steps are as follows – Choose your Mounting situation

► Recess mounting into ceiling using spring clips

- 6x6 - Actual Panel size: Overall 595 x 595mm with a hole cutout of 575 x 575mm
- 12x3 - Actual Panel size: Overall 1195 x 295mm with a hole cutout of 1175 x 275mm

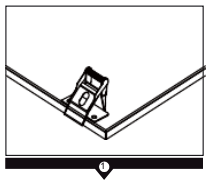

Fix spring clips provided with screws on opposite sides of each other

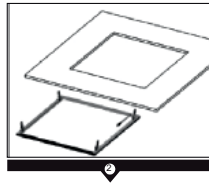

To install into ceiling cutout, Start with one side first by pushing spring clips up into hole cutout then repeat on the opposite side and push panel up into hole so it snaps up into place flush with the ceiling.

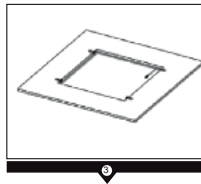

Installation complete

► T bar Ceiling Grid installation

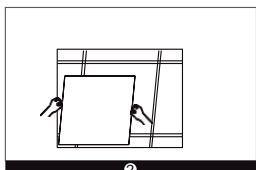

Remove 600x600mm ceiling tile from ceiling grid.

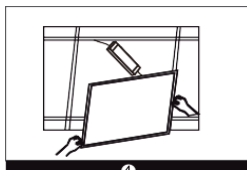

Place Skyfixture into ceiling grid

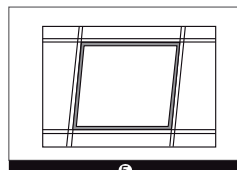

Installation complete

Surface Mounted Frame

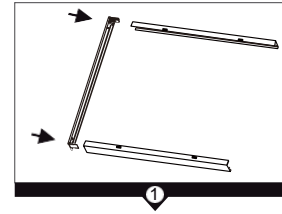

1

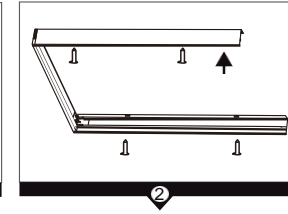

2

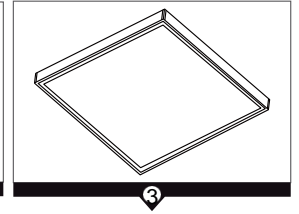

3

Assemble all 4 pieces

Fix the square frame to ceiling

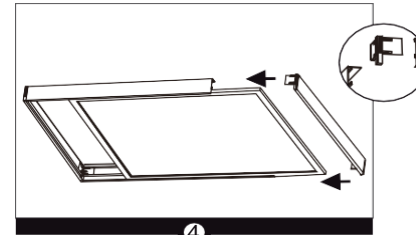

4

4. Unscrew one end of frame and remove, slide Skyfixture panel into frame then re-screw end back to frame.

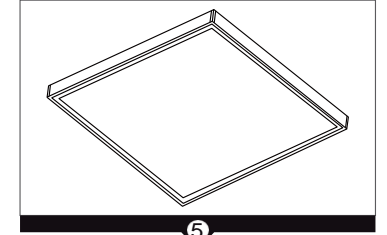

5

Installation complete

Suspension Kits

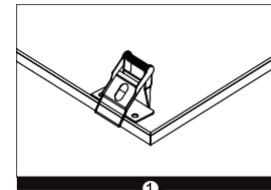

1

Remove the spring clip

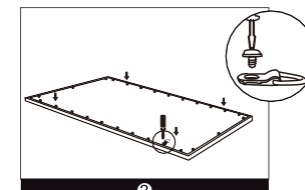

2

Mount hooks to back of light panel

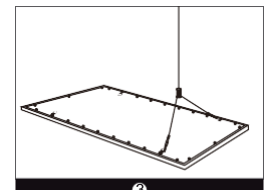

3

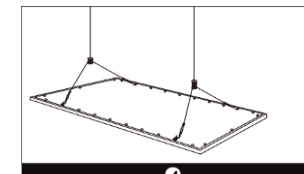

4

Secure wire or cable to a stable structure above

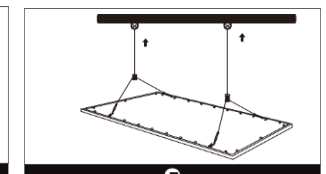

5